



# Central Wyoming College

Campus Security: 307-855-2143

Campus Services: 307-840-2342

AED Locations 

## CAMPUS BUILDINGS

- Intertribal Education & Community Center (ITECC)
  - University of Wyoming Outreach
- Robert A. Peck Arts Center
  - Art • Theatre • Music
- Main Hall
  - Classroom Wing • Library • Administration Wing
  - Foundation • Rustler Central (Enrollment Services)
- Wyoming PBS
- Student Center
  - Rusty's Corner (Food Court) • The Grind (Coffee shop)
  - Mallroom • Bookstore
- Rustler Gym
- Health & Science Center
- Boiler Plant
- Physical Plant
- Maintenance Shop
- Professional-Technical Center (Pro-Tech)
  - Welding • Automotive • Cosmetology • R-Recreation
- Rustler Ag & Equine Complex (RUSLR)
- Mote Hall
- Residence Hall
- East Apartments
- West Apartments



## Main Hall Classroom Wing



## Main Hall

### Main Hall Classroom Wing

MH157	Computer Lab
MH159	Computer Lab
MH160	Computer Lab
MH161	Classroom
MH163	Classroom
MH166	Classroom
MH167	Classroom
MH169	Classroom
MH171	Lecture
MH176-178	ABE/HEQ Offices/ Classroom/Testing
MH179	Classroom
MH181	Classroom

### Main Hall First Floor

#### Library and Testing Center

MH109	Circulation Desk
MH109	Testing Center

#### Tutor Lab

MH123	TRIO Program Staff
MH133	Computer Lab

#### Faculty and Staff Office Suites

MH135	Staff Lounge
MH141	Faculty and Staff Office Suite
MH152	Faculty and Staff Office Suite

### Main Hall Administration Wing

#### Rustler Central

MH101W	Admissions
MH101I	Financial Aid
MH101U	Student Records
MH101C	Student Life
MH101P/Q	Vice President for Student Affairs

#### Business Office

MH102A	Cashier
MH102	Business Office

#### Human Resources Office

MH102I	Director of Human Resources
MH102J/G	Human Resources Staff

#### CWC President Office Suite

MH104A/B	Vice President For Academic Affairs
MH104C/D	President
MH104F	Director of Institutional Effectiveness

#### Administrative Services

MH106B/C	CWC Foundation
MH106E/F	Vice President for Administrative Services
MH106G	Facilities Coordinator
MH106H/I	Budget Analyst/Payroll & Benefits

#### Campus Security

MH107	Campus Security Director
-------	--------------------------

### Main Hall Second Floor

#### Marketing

MH220N	Director of Marketing & PR
MH220P/R	Marketing Staff

#### Information Technology Suite

MH210	
-------	--

#### Counseling & Disability Services

MH220E/F	Counselor/Disability Services Coordinator
MH220K	Disabilities Services Coordinator





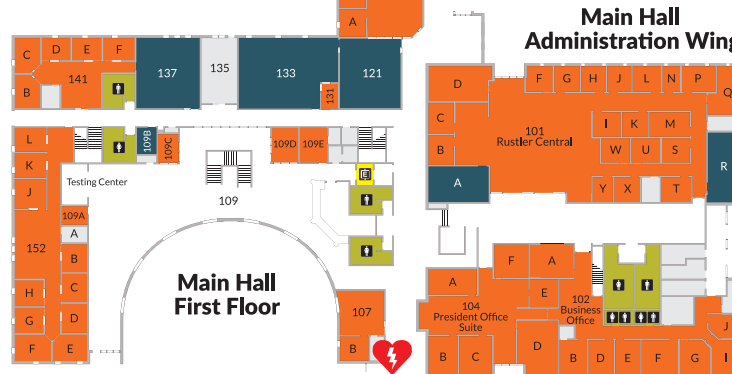

#### Library Second Floor

MH200D	Conference Room (Access through Library 1st floor entrance)
MH200E	Conference Room (Access through Library 1st floor entrance)

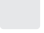

## Main Hall First Floor

## LEGEND

-  Classrooms/ Labs/ Conference Rooms
-  Office Space
-  Other
-  Public Restroom
-  Lactation Room
-  Elevator

## Main Hall Administration Wing

